

Time switch technology

Analogue time switches, Front panel/wall installation, switching segments



tactic 111 A



tactic 211 A

Description

The universal time switches from our tactic product range provide versatile application options throughout buildings and outdoors. They can be used to control swimming pools or sprinkler systems, for example.

The analogue 1-channel, surface-mounted universal switches are synonymous with simple operation and are equipped with a Quartz or synchronous drive.

tactic 111 A

- Without power reserve

tactic 211 A

- With power reserve

- Quartz controlled

Product selection

Program	Number of channels	Power reserve	Shortest switching time	Programmable every	Type of contact	Operating voltage	Type	Item no.	Available from
Daily program	1	–	15 min	15 min	Changeover contact	230 V AC	tactic 111 A	01.78.1001.1	03/2023
		5 days	15 min	15 min	Changeover contact	110-230 V AC	tactic 211 A	02.78.1001.1	03/2023

Technical data

	tactic 111 A	tactic 211 A
Operating voltage	230 V AC	110-230 V AC
Frequency	50 Hz	50-60 Hz
Type of installation	Surface mounting	
Type of contact	Changeover contact	
Program	Daily program	
Number of switching segments	96	
Number of channels	1	
Manual switch	Auto/Fix ON/Fix OFF	
Power reserve	–	max. 5 days
Drive	Synchronous motor	Quartz-controlled stepper motor
Switching output	Potential-free and phase-independent	
Switching capacity at 250 V AC, cos phi = 1	16 A	
Switching capacity at 250 V AC, cos phi = 0.6	8 A	
Incandescent/halogen lamp load	1400 W	

Analogue time switches, Front panel/wall installation, switching segments

	tactic 111 A	tactic 211 A
Shortest switching time	15 min	
Programmable every	15 min	
Time accuracy	Synchronised with mains	$\leq \pm 1.5$ s/day (Quartz) at 25 °C
Standby output	0,9 W	0,6 W
Housing and insulation material	High-temperature resistant, self-extinguishing thermoplastic	
Protection rating	IP 20	
Protection class	II as per EN 60 730-1	
Ambient temperature	-20 °C ... +55 °C	

Scale drawings

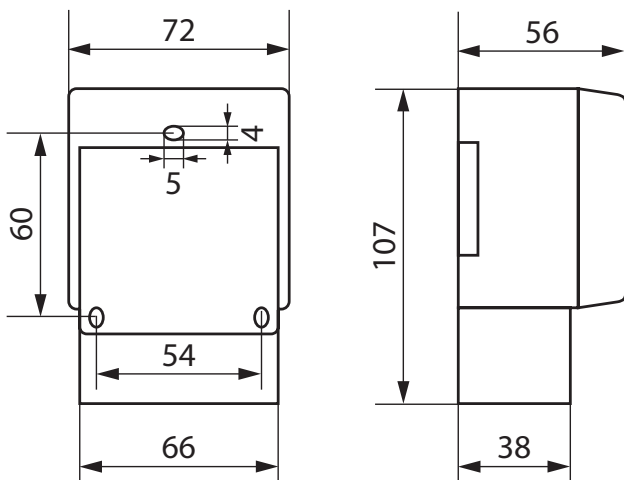

Connection example

